



PNEUMATIC

s.35 NPT high pressure

1/8"-1/2" Mini Drawn Brass Ball Valves

PATENTED



Quality:

- Dual sealing system allows valve to be operated in either direction making installation easier
- No metal-to-metal moving parts
- No maintenance ever required
- Handle clearly shows ball position
- Silicone-free lubricant on all seals
- Chrome plated brass ball for longer life
- Each valve is seal tested for maximum safety

Body:

- One piece drawn sand blasted brass body with an extreme compact design
- Finest brass according to EN 12164 specification
- Patent n. 7011-B/89

Stem:

- Blowout-proof brass stem with FPM O-ring

Seals:

- Pure PTFE self-lubricating seats with flexible-lip design

Threads:

- NPT taper ANSI B.1.20.1 female by female threads

Handle:

- Reinforced nylon wedge handle removable with valve in service

Working Pressure:

- 450 PSI
- non-shock cold working pressure

Working Temperature:

- -4°F / +200°F Warning: freezing of the fluid in the installation may severely damage the valve
- +250°F screw driver version and metal wedge handle

Options:

- Screw driver or wrench operated
- Dezincification Resistant brass CW602N
- Aluminium body
- Nylon wedge handle yellow, red or green
- Metal wedge handle available in colours red, black, yellow, green, light blue, chrome plated
- Grey wedge handle in Grivory® - high performing polymer
- Male by Female threads
- ISO 228 parallel threads

Upon Request:

- Custom design
- ISO 7/1 BSPT Taper threads





Approved by or in compliance with:

- RoHS compliant

NOTE: Approvals apply to specific configurations only

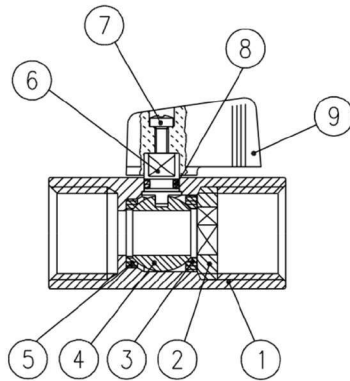

Part Description	Q.ty	Material
1 Chrome plated body	1	CW617N
2 Retainer nut	1	CW617N
3 Retainer seat	1	PTFE
4 Chrome plated ball	1	CW617N
5 Body seat	1	PTFE
6 Unplated stem	1	CW617N
7 Zinc plated screw	1	CB4FF
8 O-Ring	1	FPM
9 Black handle	1	Nylon glass filled 30%

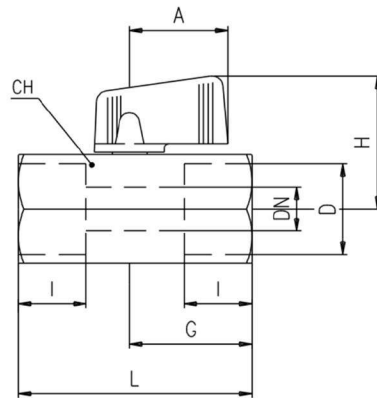

DN shows the nominal flow diameter.

Code	S35AX0	S35BX0	S35CX0	S35DX0
D (inch)	1/8	1/4	3/8	1/2
DN(inch)	0.236	0.314	0.314	0.393
I (inch)	0.354	0.472	0.472	0.610
L (inch)	1.712	1.712	1.712	2.106
G (inch)	0.905	0.905	0.905	1.102
A (inch)	0.885	0.885	0.885	0.885
H (inch)	1.220	1.220	1.220	1.299
CH(inch)	0.826	0.826	0.826	0.984

Ask for additional information on the whole range of **RuB** valves and consult with your supplier for special applications.

Pressure-Temperature Chart

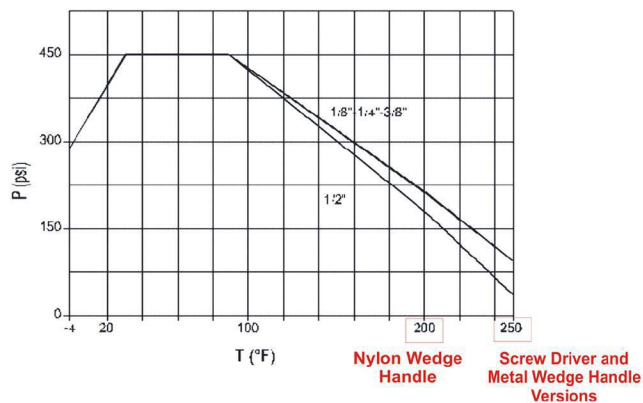

Pressure Drop Chart

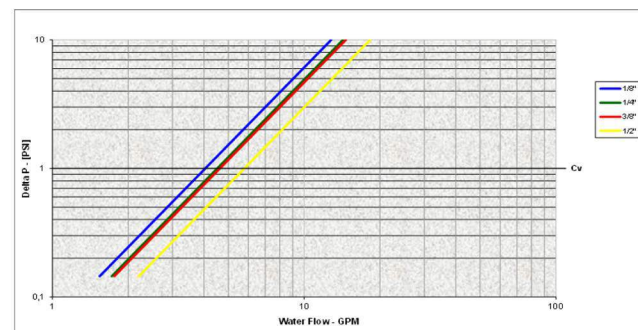



PNEUMATIC

s.34 NPT

1/8"-1/2"

Drawn Brass Ball Valves



Quality:

- 24h 100% seal test guaranteed
- Dual sealing system allows valve to be operated in either direction making installation easier
- No metal-to-metal moving parts
- No maintenance ever required
- Handle clearly shows ball position
- Silicone-free lubricant on all seals
- Chrome plated brass ball for longer life

Body:

- One piece drawn sand blasted brass body incorporating stem neck which provides excellent guidance of the stem
- Finest brass according to EN 12164 specification

Stem:

- Two FPM O-rings at the stem for maximum safety

Seals:

- Pure PTFE self-lubricating seats with flexible-lip design

Threads:

- NPT taper ANSI B.1.20.1 female by female threads

Handle:

- Reinforced nylon black lever or T-handle removable with valve in service

Working Pressure:

- 200 PSI
- non-shock cold working pressure

Working Temperature:

- -4°F
- +200°F
- Warning: freezing of the fluid in the installation may severely damage the valve

Options:

- Screw driver or wrench operated
- Yellow lever or T-handle
- Male by Female threads
- ISO 228 parallel threads





Approved by or in compliance with:

- UkrSepro (Ukraine)
- RoHS compliant

NOTE: Approvals apply to specific configurations only

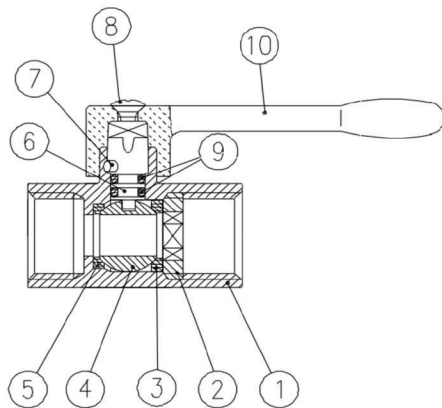

Part Description	Q.ty	Material
1 Chrome plated body	1	CW617N
2 Retainer nut	1	CW617N
3 Retainer seat	1	PTFE
4 Chrome plated ball	1	CW617N
5 Body seat	1	PTFE
6 Unplated stem	1	CW617N
7 Pin	1	AISI 304
8 Chrome plated screw	1	CW617N
9 O-Ring	2	FPM
10 Black handle	1	Nylon glass filled 30%

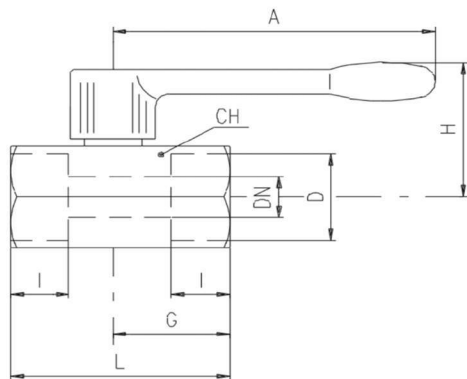

DN shows the nominal flow diameter.

Code	S34AX0	S34BX0	S34CX0	S34DX0
D (inch)	1/8	1/4	3/8	1/2
DN(inch)	0.236	0.314	0.314	0.393
I (inch)	0.354	0.472	0.472	0.610
L (inch)	1.712	1.712	1.712	2.106
G (inch)	0.905	0.905	0.905	1.102
A (inch)	2.834	2.834	2.834	2.834
H (inch)	1.200	1.200	1.200	1.279
CH(inch)	0.826	0.826	0.826	0.984

Ask for additional information on the whole range of **RuB** valves and consult with your supplier for special applications.

Pressure-Temperature Chart

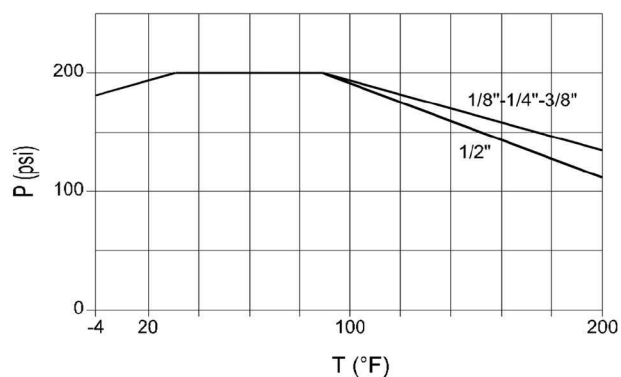

Pressure Drop Chart

