

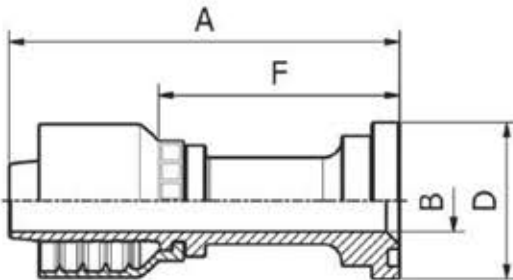

**OPF TYPE**



SAE STANDARD CONNECTIONS



**OPF23311**

**ISO / SAE  
CODE 61 FLANGE  
SAE J516 / ISO 12151-3**

PART. REF.	HOSE BORE			Flange	DIMENSIONS mm					
	DN	Dash	inch		inch	B	A	D	F	
OPF23311-08A08	12	- 8	1/2"	1/2"	9.3	82.0	30.3	51.0		
OPF23311-08A12	12	- 8	1/2"	3/4"	15.1	89.0	38.0	58.0		
OPF23311-10A12	16	- 10	5/8"	3/4"	15.0	100.0	38.0	65.5		
OPF23311-12A12	19	- 12	3/4"	3/4"	15.0	94.5	38.0	58.0		
OPF23311-12A16	19	- 12	3/4"	1"	20.0	94.5	44.6	58.0		
OPF23311-16A16	25	- 16	1"	1"	19.8	112.5	44.6	64.5		
OPF23311-16A20	25	- 16	1"	1.1/4"	26.0	118.5	51.0	70.5		

SAE STANDARD CONNECTIONS

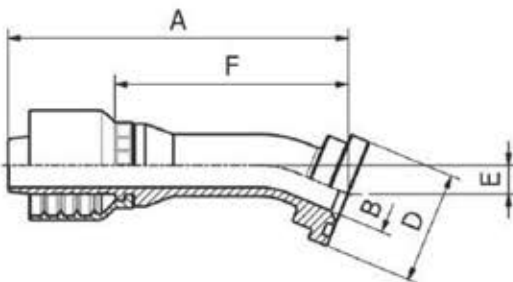

**OPF23321**

**22,5° ISO / SAE  
CODE 61 FLANGE  
SAE J516 / ISO 12151-3**

PART. REF.	HOSE BORE			Flange	DIMENSIONS mm					
	DN	Dash	inch		inch	B	A	D	E	F
OPF23321-08A08	12	- 8	1/2"	1/2"	9.3	95.0	30.3	8.0	64.0	
OPF23321-12A12	19	- 12	3/4"	3/4"	15.0	111.0	38.0	10.0	74.5	
OPF23321-12A16	19	- 12	3/4"	1"	20.0	111.0	44.6	10.0	74.5	
OPF23321-16A16	25	- 16	1"	1"	19.8	137.0	44.6	11.5	89.0	