



MULTIFIT TYPE



BS STANDARD CONNECTIONS

M30510

**BSP MALE
PARALLEL 60° CONE SEAT
BS5200 / ISO 8434-6**

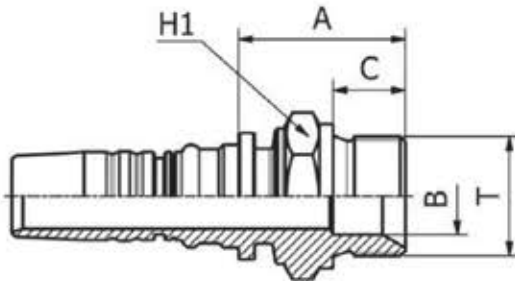

PART. REF.	HOSE BORE			Thread	DIMENSIONS mm					
	DN	Dash	inch	T	B	A	C	H1		
M30510-12-12	19	-12	3/4"	3/4" - 14	17.0	37.0	16.0	32.0		
M30510-12-16	19	-12	3/4"	1" - 11	22.5	43.0	19.0	41.0		
M30510-16-16	25	-16	1"	1" - 11	22.5	43.0	19.0	41.0		
M30510-16-20	25	-16	1"	1.1/4" - 11	28.5	48.0	20.0	50.0		
M30510-20-20	31	-20	1.1/4"	1.1/4" - 11	28.5	50.5	20.0	50.0		
M30510-24-24	38	-24	1.1/2"	1.1/2" - 11	33.5	54.5	22.0	55.0		
M30510-32-32	51	-32	2"	2" - 11	42.0	58.0	25.0	70.0		

BS STANDARD CONNECTIONS

M40812

**BSP O-RING
FEMALE 60° CONE
BS5200 / ISO 12151-6
(THRUST-WIRE NUT)**

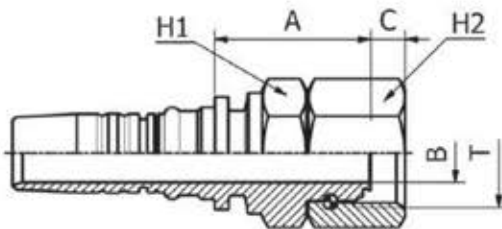

PART. REF.	HOSE BORE			Thread	DIMENSIONS mm					
	DN	Dash	inch	T	B	A	C	H1	H2	
M40812-12-12	19	-12	3/4"	3/4" - 14	14.5	39.0	8.5	32.0	32.0	
M40812-12-16	19	-12	3/4"	1" - 11	19.0	36.5	10.6	32.0	41.0	
M40812-16-12	25	-16	1"	3/4" - 14	15.0	35.0	8.5	41.0	32.0	
M40812-16-16	25	-16	1"	1" - 11	19.5	44.5	10.6	41.0	41.0	
M40812-16-20	25	-16	1"	1.1/4" - 11	26.1	41.0	10.5	41.0	50.0	
M40812-20-16	31	-20	1.1/4"	1" - 11	19.0	44.5	10.6	50.0	41.0	
M40812-20-20	31	-20	1.1/4"	1.1/4" - 11	26.1	52.5	10.5	50.0	50.0	
M40812-20-24	31	-20	1.1/4"	1.1/2" - 11	32.1	46.0	12.5	50.0	60.0	
M40812-24-20	38	-24	1.1/2"	1.1/4" - 11	26.1	48.5	10.5	60.0	50.0	
M40812-24-24	38	-24	1.1/2"	1.1/2" - 11	32.1	51.5	12.5	60.0	60.0	
M40812-32-32	51	-32	2"	2" - 11	42.0	51.5	16.1	70.0	70.0	